



**TBS** TRACHTE  
Building Systems

# DOOR & HALLWAY SYSTEMS

FOR CONVERSIONS

DESIGN. **MANUFACTURE.** ERECT.



# Trachte's Innovative Door & Hallway Solutions

## ❖ Excellence in Every Detail

As your total solution source, Trachte provides advanced door and hallway systems, tailored for new construction, climate-controlled facilities, and building conversions. Whether planning a new facility, converting a building, or adding interior corridors, Trachte has the perfect solution from design to installation.

### For New Construction:

Enhance your new building projects with Trachte's versatile door and hallway systems. Choose from swing or roll-up doors, paired with our sleek flush jamb and header system, customizable in various heights. Additional options like galvanized supports, wire mesh, diamond plate accents, and burglar bars boost security and functionality. Our hallway walls, available in flush or ribbed panel designs, offer a tailored fit and aesthetic for your building.

### For Conversions:

Trachte's conversion system is a cost-effective solution for turning existing buildings into storage facilities. Save on construction costs by using properties already zoned for commercial use. Our freestanding system, ideal for both new and existing structures, allows for customized door and hallway configurations that optimize space, tailor unit mixes, and increase rental income.



### Design, Manufacturing, and Erection All in One

At Trachte, we handle everything—from design to manufacturing and erection. This streamlined process ensures high-quality results and accountability at every step, delivering consistent excellence and peace of mind.

### In-House Door Manufacturing

We manufacture our self-storage doors in-house, allowing us to maintain strict quality control and customize each door to your facility's needs. Our doors are built for durability, security, and ease of use, ensuring reliable, long-lasting performance.

### Sleek, Clean Design with Flexibility

Our door and hallway systems combine aesthetics and functionality. Designed for flexibility, they accommodate various layouts and space requirements, whether for new builds or conversion projects, creating a modern, professional look.

### Sales Experience and Customer Support

Trachte's experienced sales team guides you through the entire process with expert advice and tailored solutions. Our commitment to customer support continues long after the sale, ensuring your facility's ongoing success.

## ❖ The Perfect Fit For Your Next Project

### For Investors & Developers:

**Streamlined Supply:** Get all your doors and hallway components from one source—Trachte. Our systems are easy to install, with major retail brand colors stocked at no extra cost.

**Single Point of Contact:** Enjoy seamless shipment and installation with a dedicated contact for efficient project management.



*Trachte provides a complete partition system for new and existing buildings*

### For Architects:

**Customizable Designs:** Trachte is your trusted partner for custom designs in the self-storage industry. We provide detailed shop drawings and specs to tailor solutions with industry-standard dimensions. Our systems offer various heights, roll-up or swing doors, diamond plate trims, false doors, liner panels, and other steel components to meet your project's unique needs.

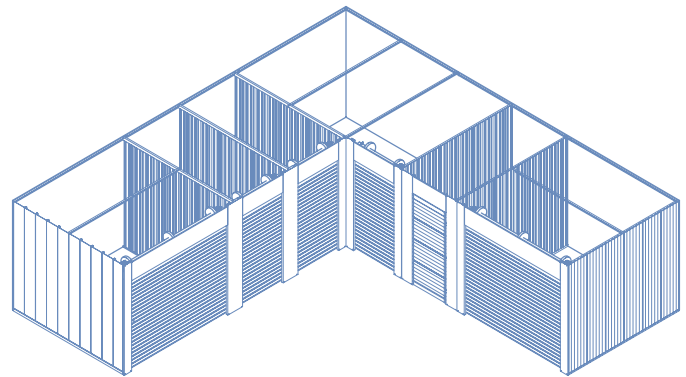

*Trachte Door and Hallway Systems are easy to specify*

### For General Contractors:

**Reliable Partnership:** Trachte ensures timely, budget-friendly projects. We offer the right products, optional labor services, and a dedicated project manager to keep everything on track, delivering quality and consistency every step of the way.



*Trachte designs, engineers, fabricates and installs multi-story mezzanine systems*



## ❖ No Surprises with Trachte

### Comprehensive Quoting:

Unlike many competitors, Trachte provides a complete, transparent quote based on an approved floor plan. This ensures all necessary components are included without unexpected charges, fully detailed in every proposal.

### Reliable Pricing:

Set your budget with confidence. In the pro forma construction world, establishing a budget number you can trust for the interior of your building is critical. Trachte's pricing strategy removes uncertainty and risk for this big-ticket portion of your project. Trachte's contracted pricing is held firm through the agreed upon ship date.

### Experienced and Knowledgeable:

Our sales, engineering, and field services teams are true experts in the self-storage industry. Many of our Trachte employees bring firsthand experience, as they own and operate their own self-storage businesses.

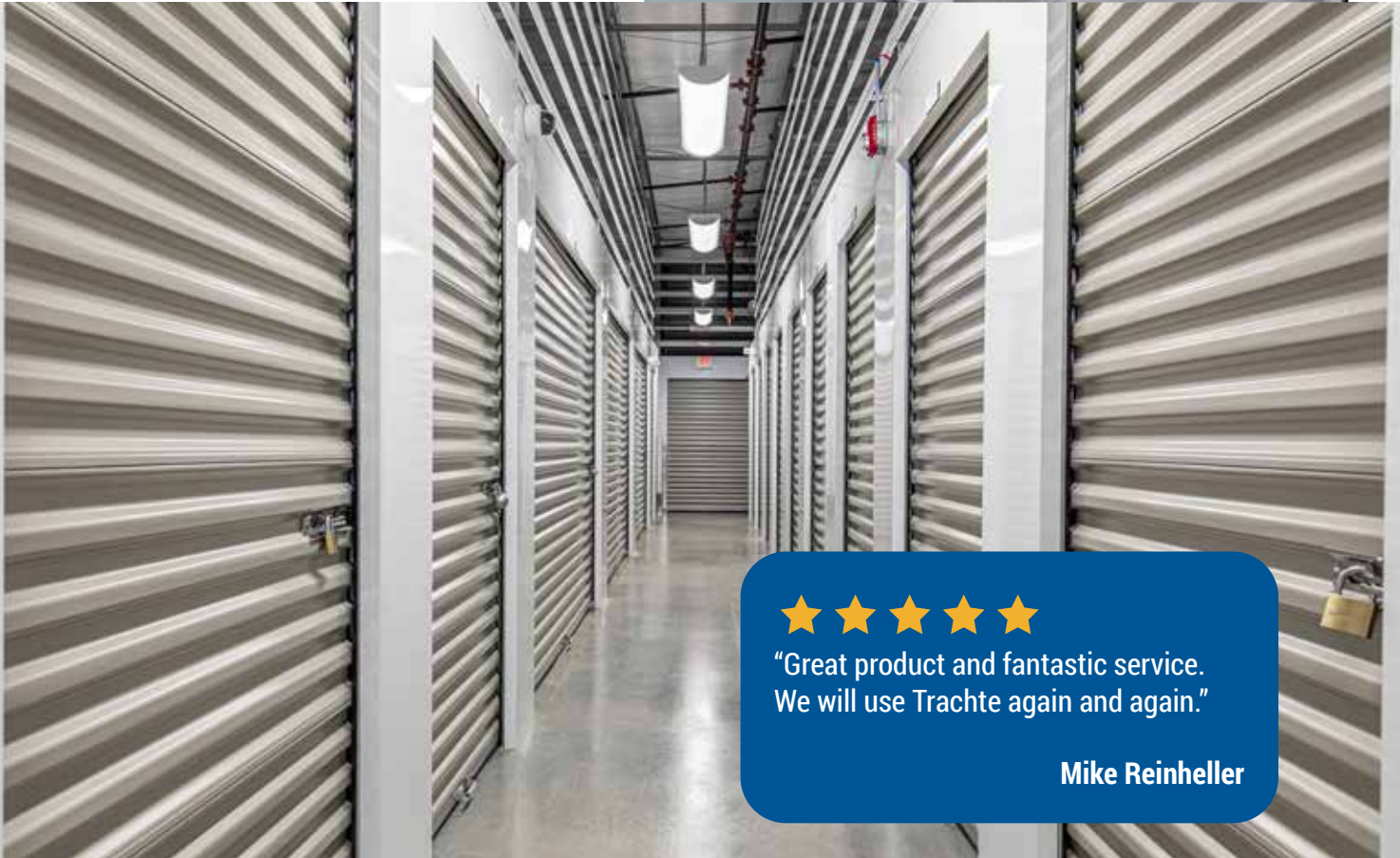

"Great product and fantastic service.  
We will use Trachte again and again."

Mike Reinheller

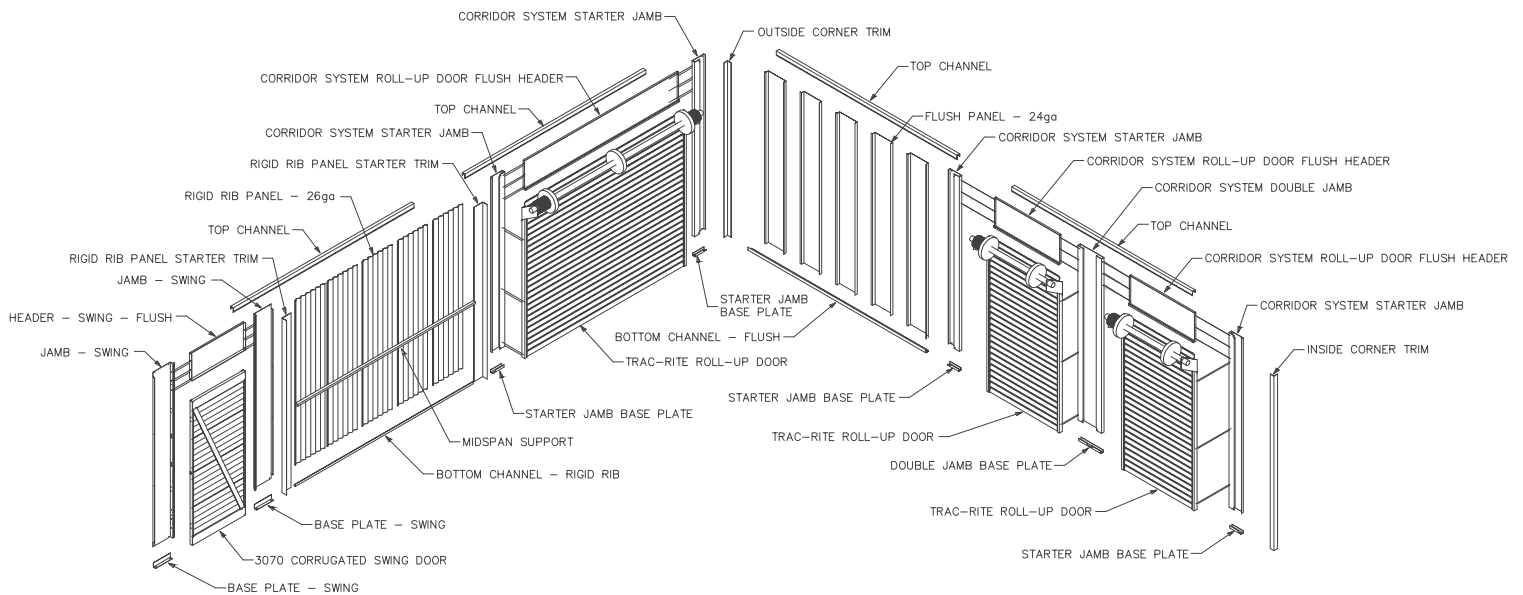

## YOUR TOTAL SOLUTION SOURCE FOR CONVERSIONS & NEW CONSTRUCTION

### Features and Options

#### Burglar Bars

Install bright white or galvanized bars above units for security with airflow.

#### Ribbed or Flush Walls

Hallways feature ribbed bright white panels, with an option to upgrade to cleaner-looking 24 gauge flush panels.

#### Ceilings

Choose from optional flush ceilings or upgrade to soffit ceilings with LED troffer lights.

#### Narrow Jamb

Allows for wider doors.

#### Wire Mesh

Available as an affordable option for unit top security, providing low-cost protection for units with open access from above.

#### Diamond Plate Trims

Various options for improved aesthetics and durability.

#### EP3 Spring

Maintenance-free, 10-year warranty helical torsion springs, coated for longevity and lubrication-free. Includes felt tape for smoother operation.

#### Tensioner System

Durable, die-cast spring tensioner for precise door operation adjustment.

ADA compliant packages available.



### Latches



Passport Smart Lock  
No active network or internet required.



The SpaceGuard latch is standard and delivered factory installed.



Stainless steel latches (field installed) also available.



#### Custom Options

The doors can be ordered with 2-bolt or 4-bolt pre-punched holes depending on your latch options. This allows compatibility with automated locking systems, Passport Locks, Chateau latches (as shown), or other latches with standard bolt patterns.

System Height	Door Opening Height
7'	6'8" (swing doors only)
7'6"	7' (swing doors only)
8'	6'8" roll-up doors or 7' swings
8'4"	7' roll-up doors
8'6"	7' roll-up doors (standard height)
9'	7' roll-up doors
9'6"	7' roll-up doors
10'	7' roll-up doors

## The Self-Storage Experts

Trachte Building Systems, established in 1901, has been a pioneer in steel self-storage buildings since the 1970s. We offer the industry's most comprehensive resources, including online content, leading seminars, and complete services in design, engineering, door production, building fabrication, and erection.

## Employee Owned

As an independent, employee-owned company, each project at Trachte is handled with a personal commitment to excellence, focusing on long-term relationships and shared success.

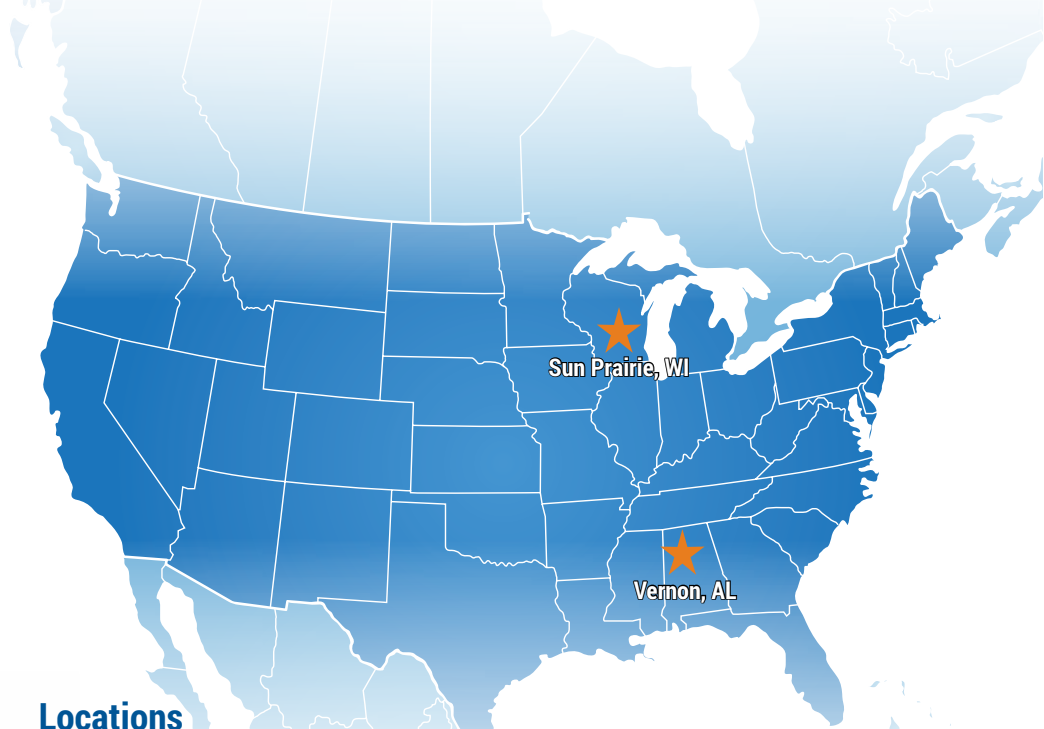

## Locations

Trachte manufactures and ships from two strategic locations: Sun Prairie, WI and Vernon, AL. Both facilities are responsible for the production of building components and doors, ensuring they are manufactured to the highest standards. Trachte has made significant investments in automation and continues to prioritize growth, enabling the delivery of exceptional products and services to customers across North America.



## Wall Color

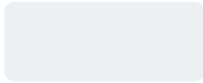

BRIGHT WHITE

**Note:** Colors shown are printed samples on paper. Colors vary from actual material. For an accurate color sample, please contact Trachte Building Systems at 800-356-5824 to request a metal sample.

## Door Colors



CEDAR RED



GARNET



CRIMSON RED



PATRIOT RED



SUNSET ORANGE



UB YELLOW



BRIGHT WHITE



ICED WHITE



LIME GREEN



WASABI GREEN



EVERGREEN



FERN GREEN



TEAL



POLAR BLUE



ROYAL BLUE



DESERT TAN



LIGHT STONE



ASH GRAY



SILHOUETTE GRAY



DARK CHARCOAL GREY



SHALE



CONTINENTAL BROWN



BURNISHED SLATE



MATTE BLACK

Trachte's dedicated team will be delighted to assist you further and provide any additional information or clarification you may need.

2630.MKT.0824



Scan to Learn More

For more information, please contact us:

800-356-5824 ■ [tbs@trachte.com](mailto:tbs@trachte.com)  
314 Wilburn Road, Sun Prairie, WI 53590-1469